

VANITY PLANET

Essia

ULTRASONIC LIFTING
& EXFOLIATING WAND

USER GUIDE

Contents

Includes.....	1
Your Essia.....	2
Instructions.....	3
Upkeep.....	12
Safety.....	14
FAQ.....	16
Specs.....	17
Warranty.....	18

- Essia - Ultrasonic Lifting and Exfoliating Wand
- Charging Base
- AC Adapter
- User Guide

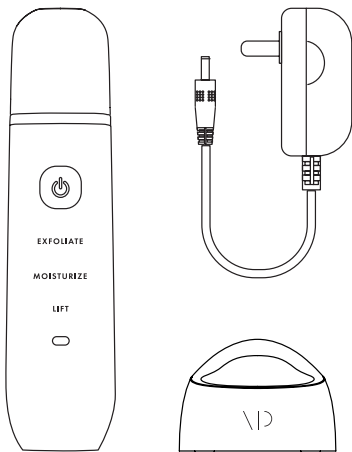

Your Essia

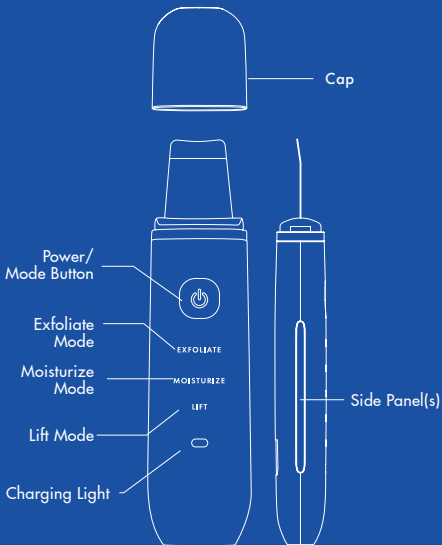

Instructions

PREP

Before using Essia, wash your face, making sure to remove makeup and surface-layer debris. Then, apply your favorite moisturizer, serum or water.

MODE SELECTION

To turn Essia on, press and hold the Power Button.

Then, continue to press the button until you've selected the mode you would like to use.

Note: If not used, Essia will turn off after 15 seconds.

Exfoliate Mode

To exfoliate, gently press the back of the wand head against your moisturized (or damp) skin at a 30-degree angle and begin slowly moving the wand forward. You'll notice the ultrasonic waves and wand head loosening blackheads and clearing away dead skin and dirt.

Skin Surface

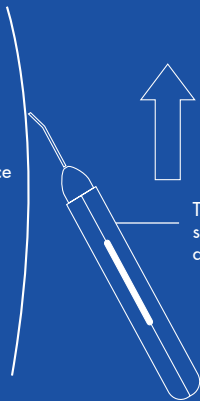

The Power Button
should be facing
away from you.

Moisturize Mode

Looking to make the most of your favorite moisturizers and serums? Just apply the product of your choice and activate Moisturize Mode. Then, press the front of the wand head to your skin at a 30-degree angle, slowly moving the wand backwards. Make sure to hold both side panels when using this mode—it completes the anion circuit and allows the microcurrent to better penetrate your skin, stimulating your cells and enhancing the absorption of your skincare product.



Gently move the device upwards.



Make sure the device is facing down.

Skin Surface



The Power Button should be facing towards you.

Lift Mode

To firm and tighten your skin, grip the wand facing downwards and press the front of the wand head to your skin at a 30-degree angle, slowly moving the wand upwards. Make sure to hold both side panels to complete the EMS circuit, allowing the microcurrent to penetrate your skin, stimulating your muscles and helping to reduce the appearance of fine lines and wrinkles.



Gently move the device upwards.



Make sure the device is facing down.

Skin Surface



The Power Button should be facing towards you.

Using Essia

TAILOR YOUR SKINCARE ROUTINE:

Transition from Exfoliate Mode to Moisturize Mode to Lift Mode for a thorough regimen or pick and choose modes based on your needs—it's completely up to you.

We recommend following the sequence below:

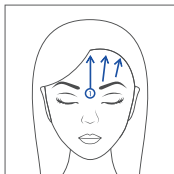

Forehead

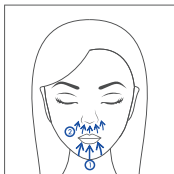

Chin, areas around mouth

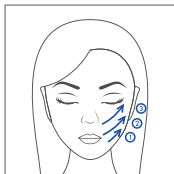

Cheeks

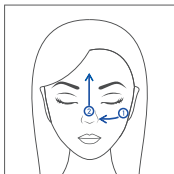

Nose, areas around nose

TIPS

- Feel free to use each mode for two or more minutes but make sure not to exceed six minutes
- Use Essia once or twice a week (depending on your skin's sensitivity)
- After using Essia, continue with your daily routine (toners, lotions, etc.)

CHARGING

To charge Essia, place the wand on the charging base and connect the AC adapter.

- While charging, the wand's light will flash red
- Once charged, the light will turn solid blue

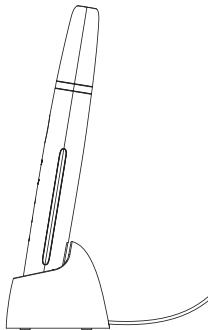

Upkeep

CLEANING ESSIA

- To clean the head of the device, use a dry tissue, soft cloth or towel
- If a stain is particularly hard to remove, try using a damp cloth

STORAGE

- Make sure to replace the cap when you're done using the wand
- Store the wand and accessories in a cool, dry place
- Make sure to turn off the wand before storing it
- Try not to excessively squeeze or put pressure on the wand
- Make sure to disconnect the adapter before storing the wand

Say hello
to true
beauty.

Safety

For the best results and to prevent injury or damage to the product, please carefully read these safety warnings and follow the user guide instructions when using your wand.

- Only plug your device into 100-240V outlets
- Don't wrap the cord around the power connector
- To avoid fires or shocking yourself, don't bend, twist, stretch, squeeze, tie, clamp or heat the power cord
- Don't try to charge the wand if the power cord or power connector is broken or if wires are exposed
- Avoid exposing the wand, power cord or charging base to water and don't use the wand if your hands are wet
- Don't use the device if you have implanted medical devices (i.e. pacemakers, etc.)

If you have sensitive skin, are taking a dermatologist-related medication or are undergoing treatment, are pregnant or have pre-existing medical conditions, please consult your physician before using the wand.

OTHER WARNINGS

Don't use the device around your eyes, ears, in your mouth or on wounds, facial melasma, acne, inflamed skin, rashes or areas that have undergone plastic surgery.

TIPS

- Make sure to remove the adapter from the power outlet when not charging the wand
- Don't try to repair or disassemble the device on your own
- Avoid dropping the wand
- Don't share the wand
- Don't use the wand on dry skin
- Don't use the wand if you've undergone IPL hair removal or if you are sunburned
- Make sure to avoid repeatedly going over the same area of skin
- Don't use the wand with scrubs or exfoliators
- Make sure to remove contacts, earrings, necklaces or other accessories before using the wand
- Keep out of reach of children
- If, while using the wand, you feel unwell in anyway, stop using the device immediately and consult your physician

FAQ

Why won't the wand turn on?

This might be because the wand isn't charged. If charging the wand doesn't fix the problem, please contact our Customer Experience Team.

Why won't the wand charge?

Essia features a protection state that it will enter if it isn't used after a long period of time. This ensures the integrity and lifespan of the battery. To return the wand to its normal state, simply charge the device for 15 minutes to reactivate the battery. The light will flash red, meaning Essia can be recharged again. We recommend replacing the battery every six months.

How long does the charge last?

It takes about 12 hours to charge the wand and each charge should last about 120 minutes.

Why is the Charging Light flashing?

In most cases, this means the wand needs to be charged.

Specs

Model No.	VP59312-0100
Dimensions	175.5 x 43.5mm x 22mm
Net Weight	Approx. 106g
Battery	Lithium batteries
Working Time	120 minutes
Charging Time	12 hours
Power	2.3W at maximum
Input Voltage	100-240V
Output Voltage	DC 9V
Current	500mA
Power Cord Length	1.2m
Available Color	White
Operating Temperature	40-50°C
Water Resistance	IPX5

One-Year Warranty

**Visit vanityplanet.com/warranty
to register your product and
activate your warranty.**

This Vanity Planet product is warranted to be free of manufacturer's defects in materials or workmanship for one year from the date of purchase. Damage or wear resulting from an accident, misuse, abuse, commercial use, or unauthorized adjustment and/or repair are not covered under this warranty.

Should this product require warranty service (or replacement at our discretion), please contact client services. Proof of purchase is required. Products returned without prior authorization from Vanity Planet will not be accepted and the sender will not receive a refund or replacement.

**vanityplanet.com
info@vanityplanet.com
1.888.870.2132**

There are no express warranties except as listed above. This warranty gives you specific legal rights and you may have other rights which vary from state to state.

Please do not return this product to the retailer. Contact us directly for warranty service.